

AREA	SQ. FT.
LIVING 1st	1737
LIVING 2nd	840
LANAI 1st	420
PORCH 2nd	126
DECKS & WALKWAYS 1st	195
ENTRY	117
	3943

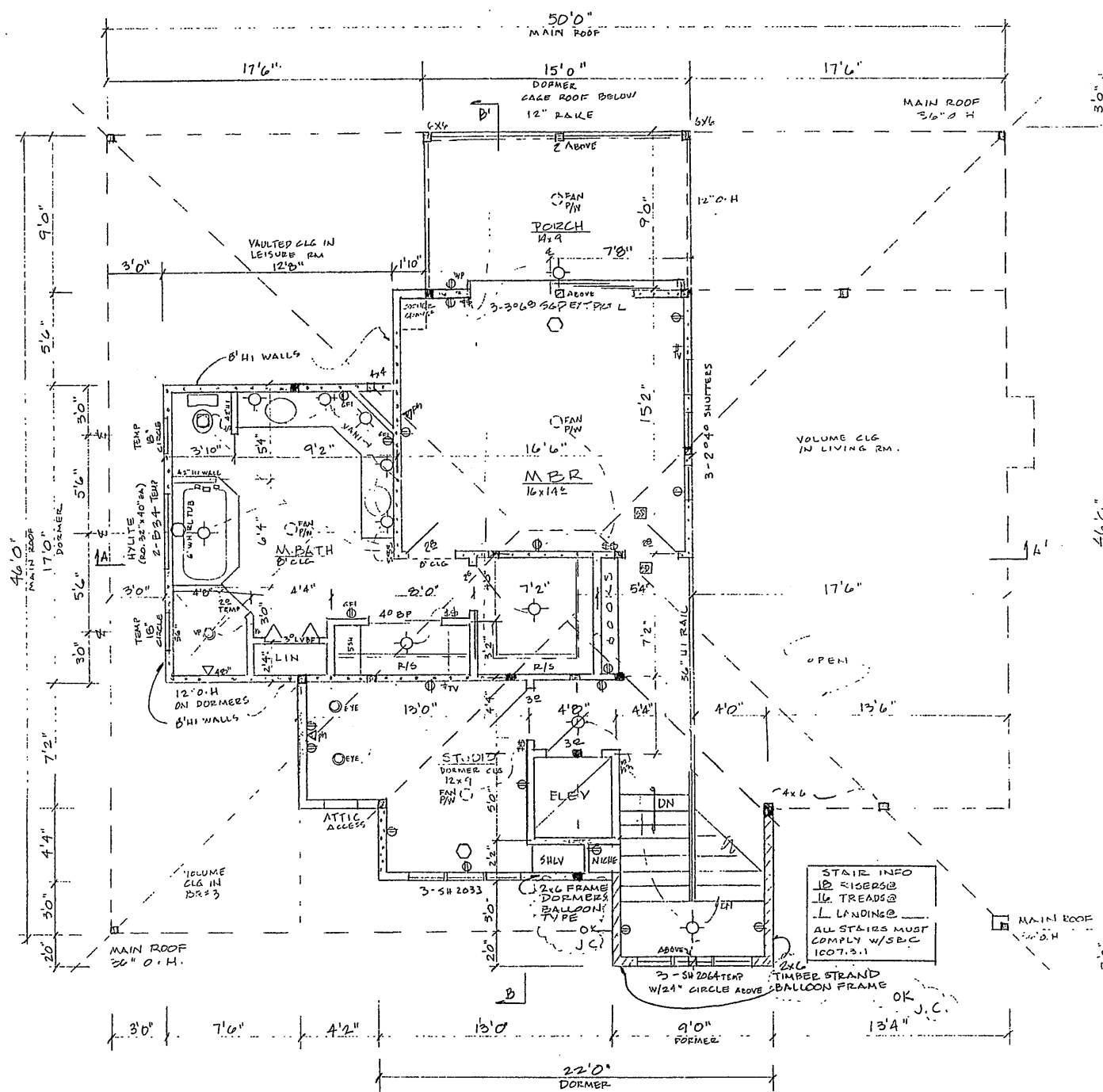

UPPER FLOOR PLAN 1/4"

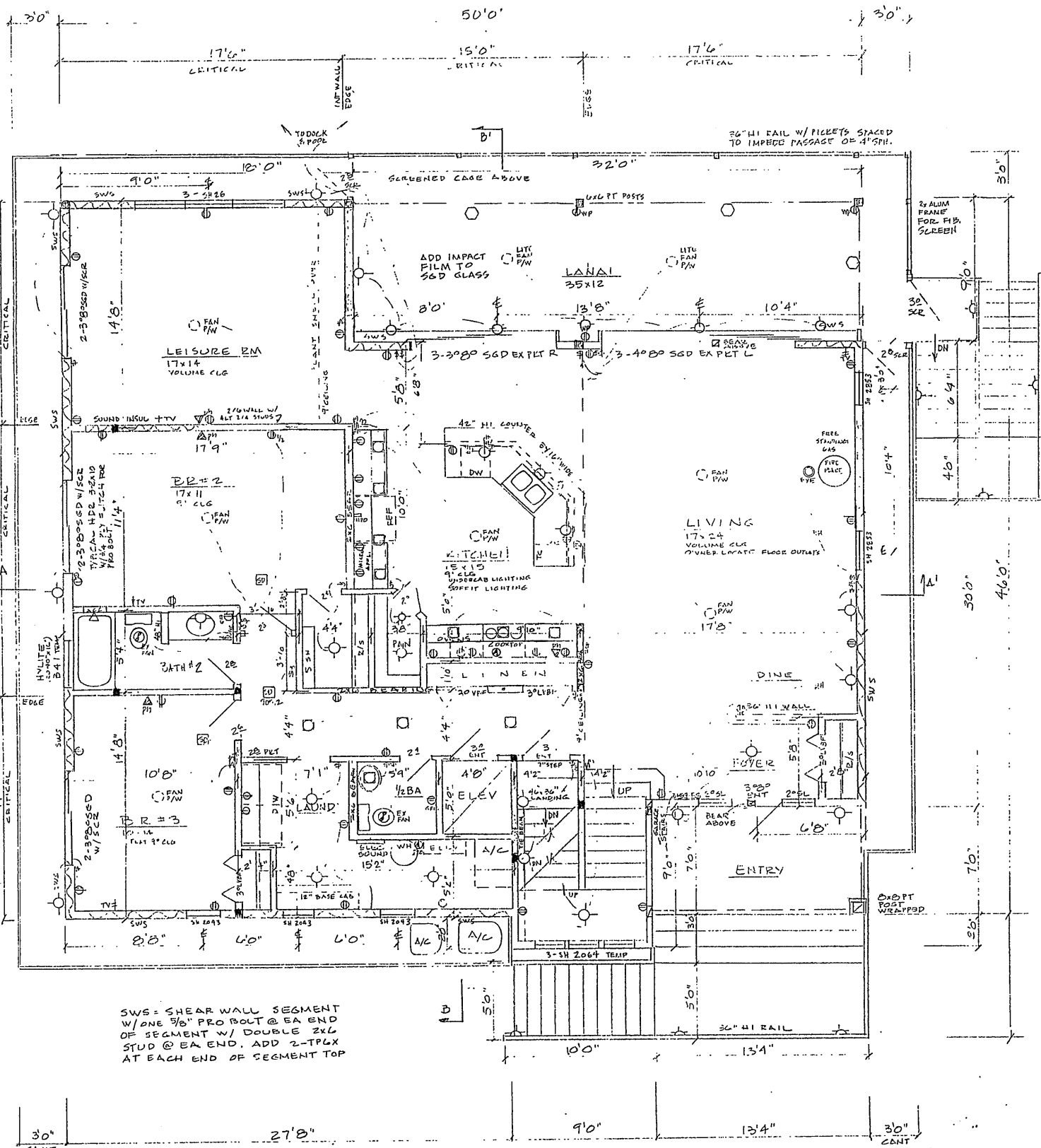

MAIN FLOOR PLAN 1/4"

Cliff's Webster Engineers
900 Pine Street, Suite 225
Englewood, Florida 34223
ph. 475-7981 fx 474-4285

GVE Job #4875
"THESE PLANS ARE DESIGNED IN COMPLIANCE WITH SECTION 1606.2 OF THE STANDARD BUILDING CODE FOR THE 110 MPH WIND ZONE."

SHEET RESIDENCE FOR JOHNN & FEM SARTORIUS BUILT BY: BAYFRONT BUILDERS
 REVIEW: 3-28-24 3-6-201
 24 ALUM FRAMES FOR FIB. SCREENS
 30" HI RAIL W/ FLEETS SPACED TO IMPROVE PASSAGE OF 4" SH.